

VERT. DATUM NAVD 88
HORIZ. DATUM NAD 83

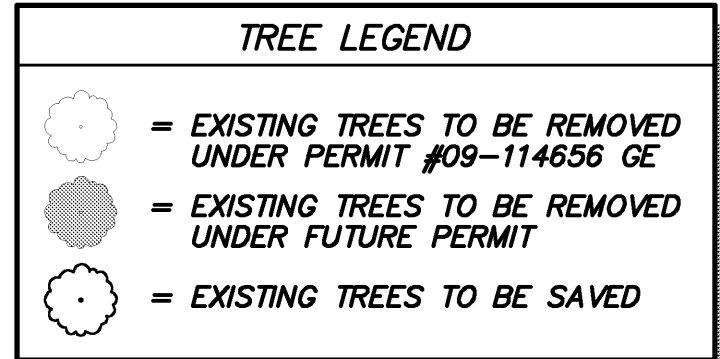

TREE NOTE:
CONTRACTOR TO COORDINATE ALL STREET TREE REMOVAL WITH MIKE HAUER (425) 452-4480 OF THE PARKS DEPARTMENT

THE EXISTING PLANTER STRIP TO BE RELOCATED HAS EXISTING IRRIGATION AND THE CONTRACTOR MUST CALL MIKE HAUER (425) 452-4480 OF THE PARKS DEPARTMENT TO COORDINATE CARE OF IRRIGATION SYSTEM DURING CONSTRUCTION.

CAUTION
LOCATION OF EXISTING UTILITIES SHOWN IS APPROXIMATE AND MAY NOT BE ACCURATE OR ALL INCLUSIVE. IT IS THE CONTRACTOR'S RESPONSIBILITY TO FIELD VERIFY LOCATION OF UTILITIES PRIOR TO PROCEEDING WITH CONSTRUCTION. YOU MUST CALL 1-800-424-5555 NOT LESS THAN 2 FULL BUSINESS DAYS BEFORE BEGINNING EXCAVATION WHERE ANY UNDERGROUND UTILITIES MAY BE LOCATED. FAILURE TO DO SO COULD MEAN BEARING SUBSTANTIAL REPAIR COSTS.

ALL EXISTING SURFACE STRUCTURES SHALL BE ADJUSTED TO MATCH PROPOSED FINISH GRADE. COORDINATE WITH ASSOCIATED UTILITY PURVEYOR PRIOR TO CONSTRUCTION. ALL JUNCTION BOXES WITHIN PLANTER STRIP SHALL HAVE A WEATHER TIGHT LID.

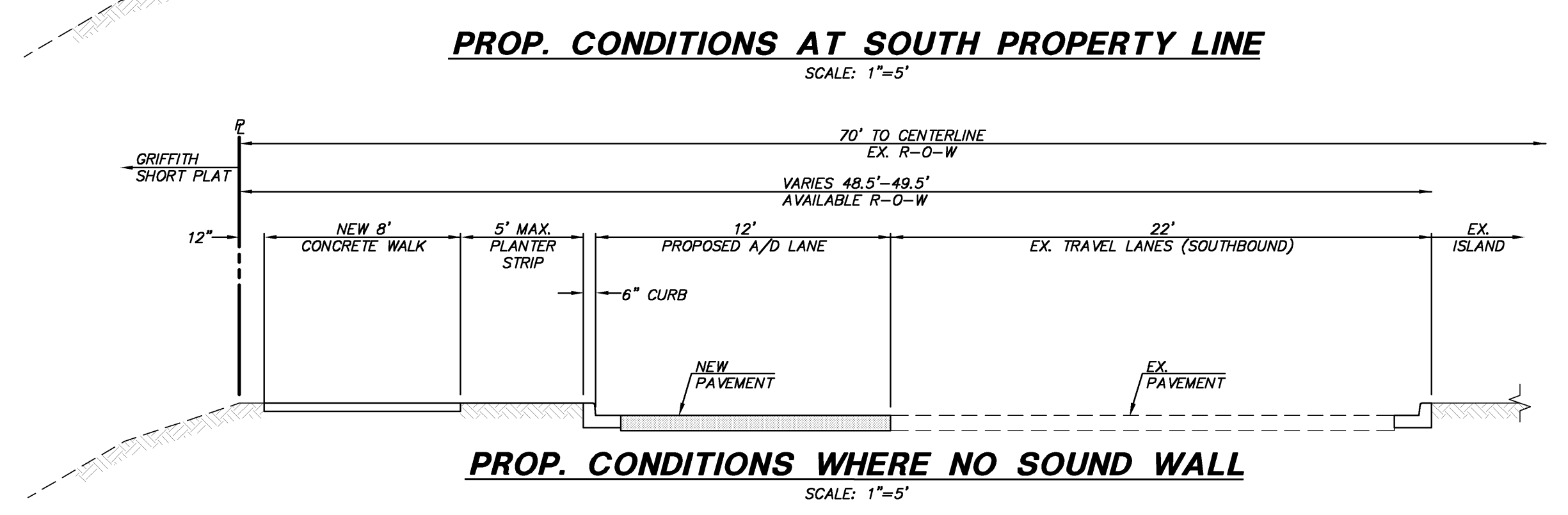
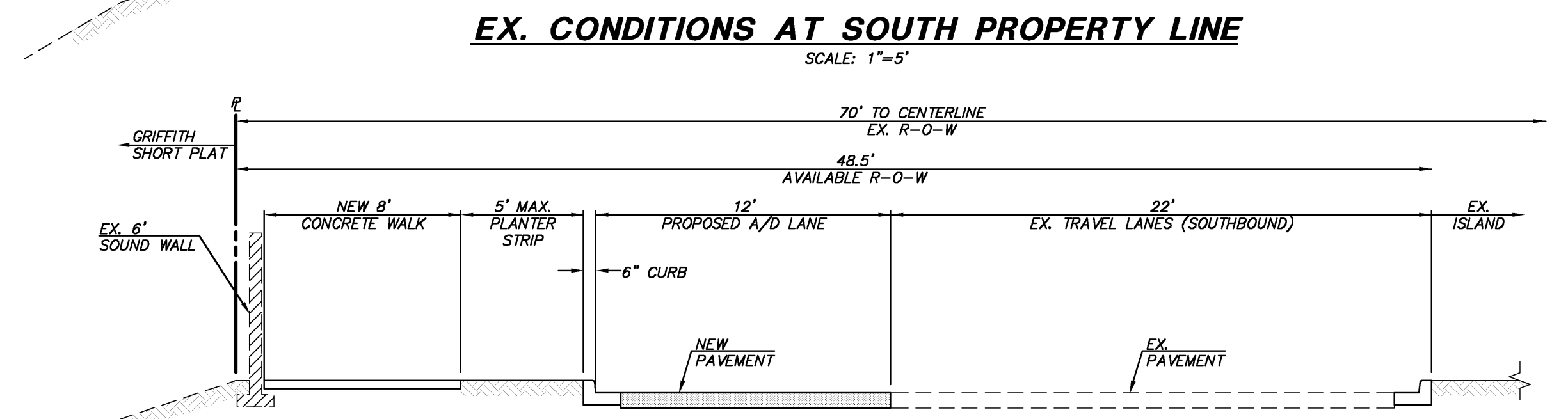
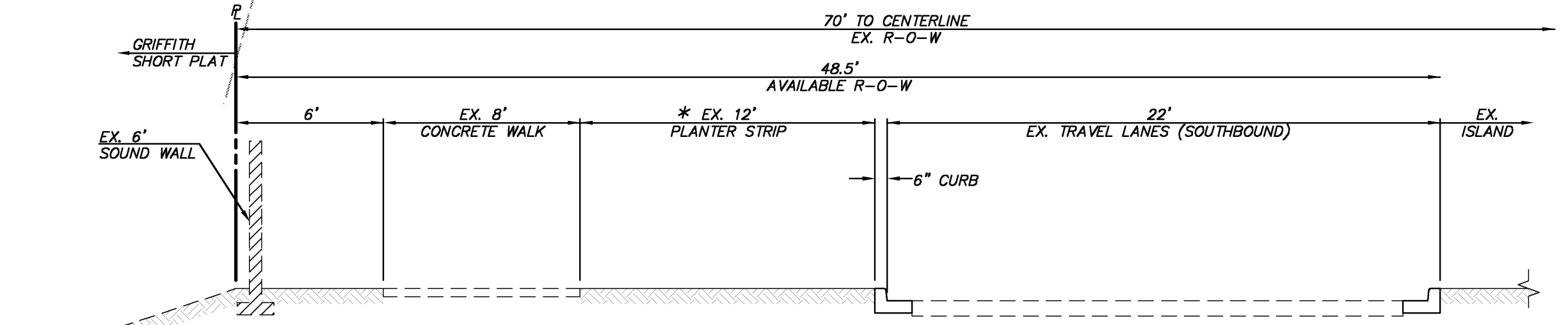
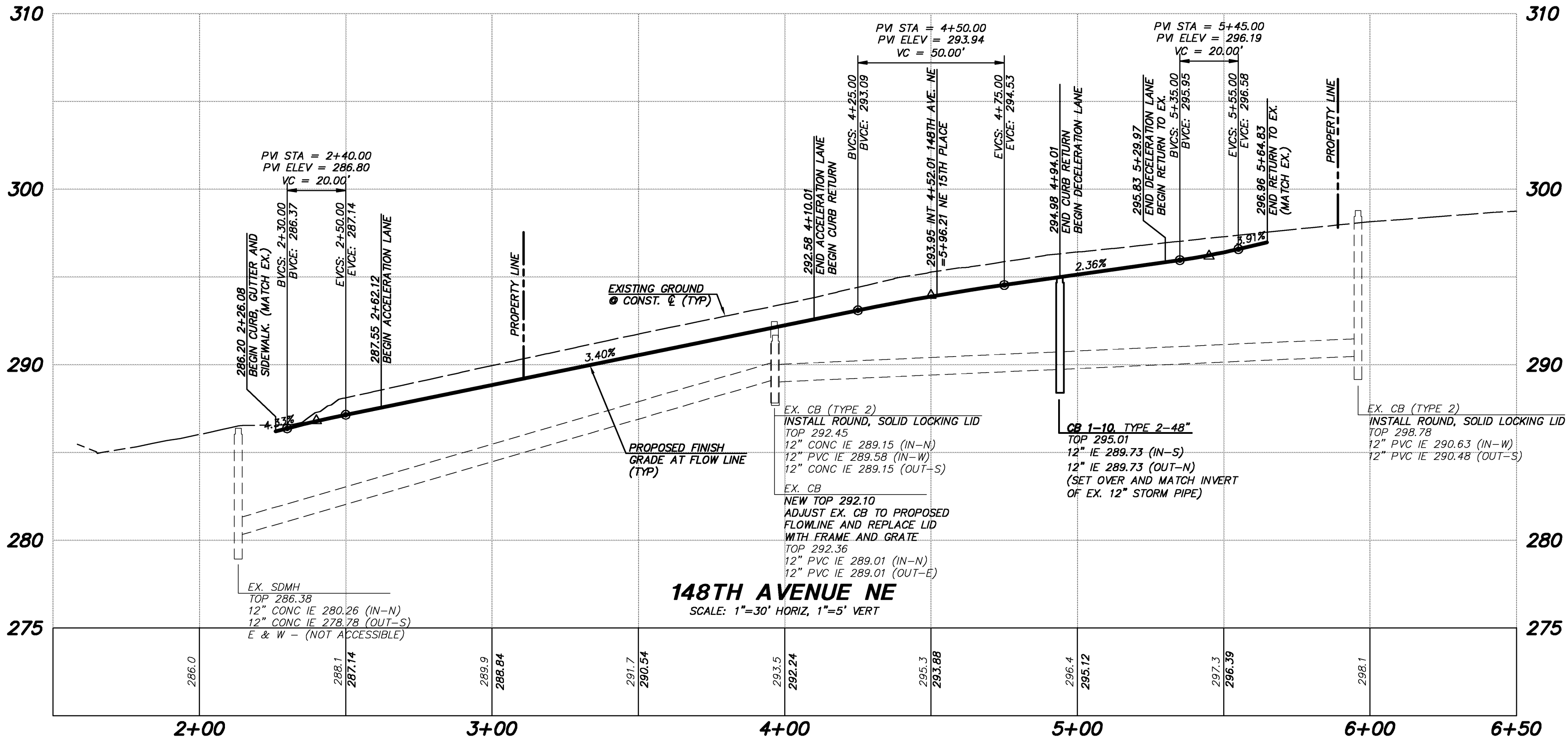
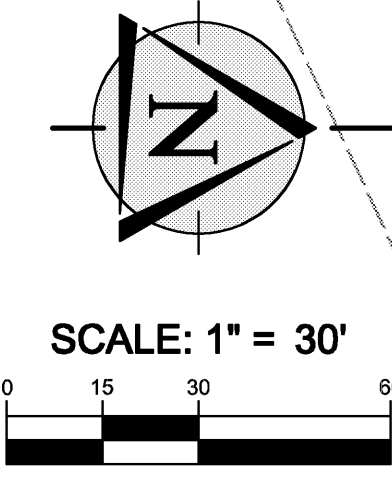

NO	DATE	BY	APPR	REVISIONS
1	11/17/09	DAM	RAT	PER CITY COMMENTS
2	3/20/10	DAM	RAT	PER CITY COMMENTS

TRIAD ASSOCIATES
Land Development Consultants
12112 115th Ave. NE
Kirkland, WA 98034-6929
425.821.8448
425.821.3481 fax
800.488.0756 toll free
www.triadassociates.net

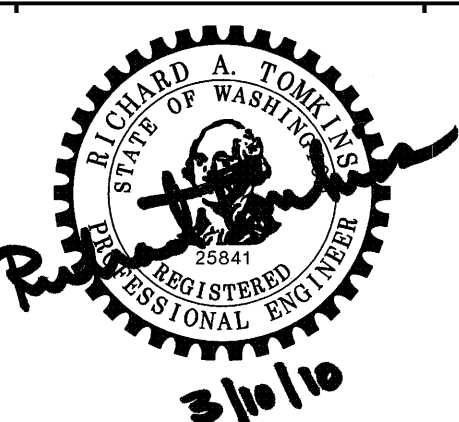

RICHARD A. TOMKINS, PE
PROJECT MANAGER
ROBERT E. WALLIS, PLS
PROJECT SURVEYOR
RICHARD A. TOMKINS, PE
PROJECT ENGINEER
JEFFREY L. COX, ASLA 6/5/09
LANDSCAPE ARCH DATE
SCALE:
HORIZ: 1"=30' VERT: AS SHOWN

GRIFFITH
1405 148TH AVE NE
09-114657 UE
CITY OF BELLEVUE, WASHINGTON

UTILITY GRID #	GRID J-6
FRONTAGE IMPROVEMENT PLAN AND PROFILE	
JOB NUMBER:	05-289
SEC 27 TWP 25 RGE 5	SHT 6 OF 9